

Create a Desktop Shortcut

1. Copy hyperlink

<https://www.wtps.org/Page/29171>

2. Right click on an open space in your Desktop

3. Drag cursor over "New"

4. Drag cursor over "Shortcut", and click

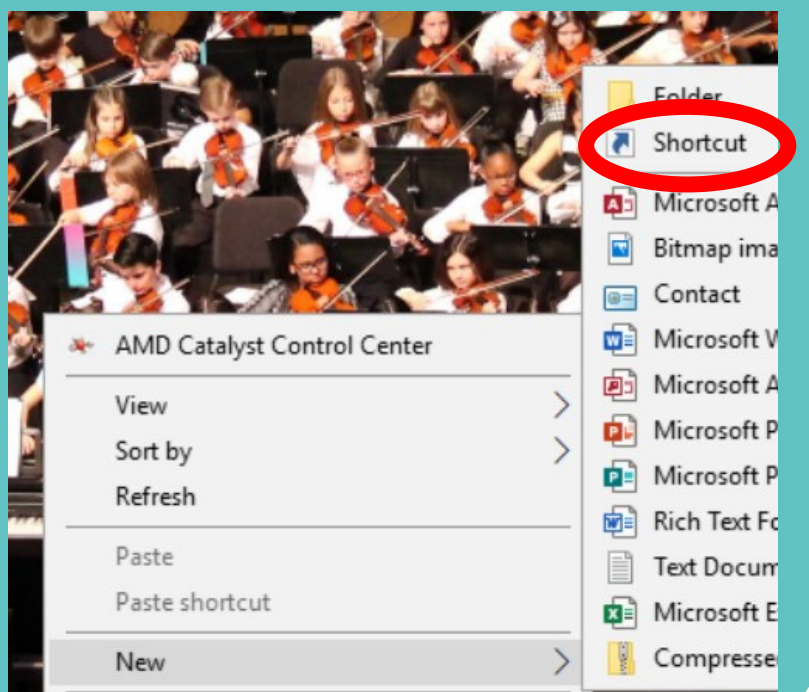
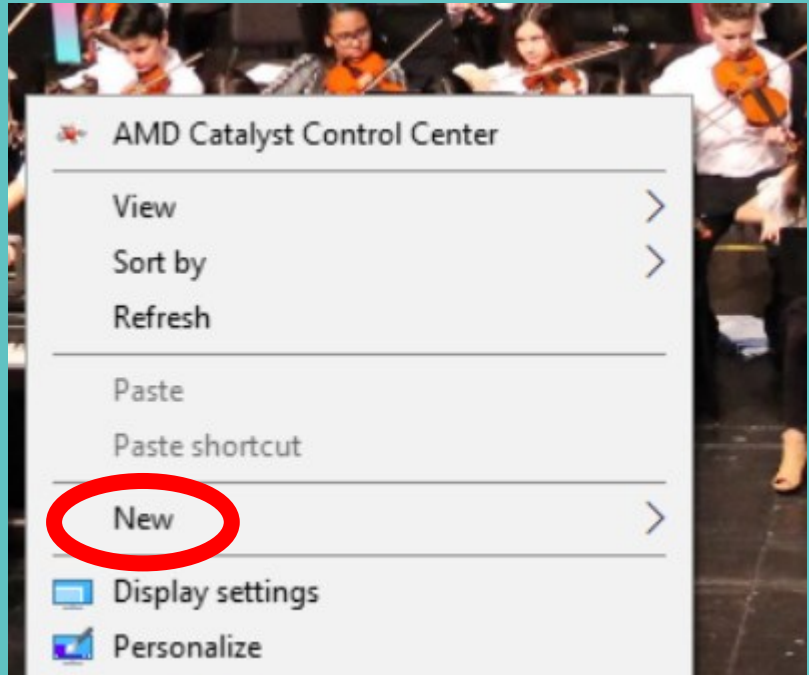

5. Below “Type the location of the item:” right click in the open box and paste the link to the play-a-long

6. Click “Next”

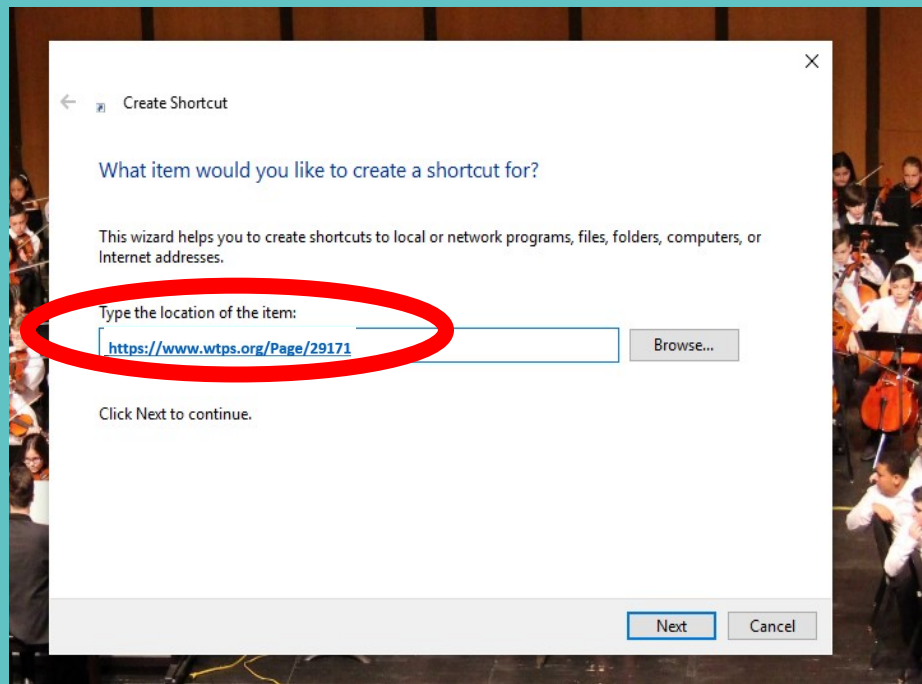

7. Below “Type a name for this shortcut:” Left click in the open box and type the title of the musical piece

8. Click “Finish”

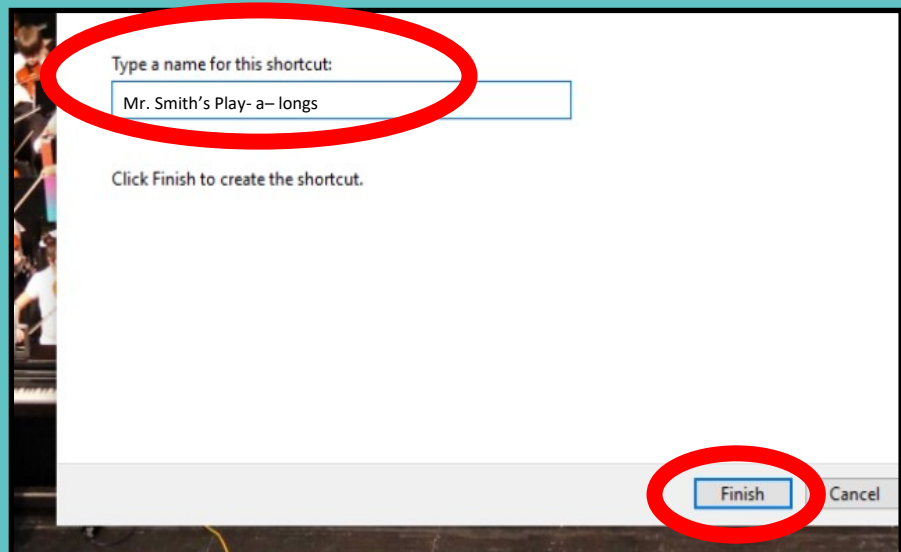

9. your new Icon will appear on the desktop



10. Click the icon to start the play-a-long